



Item pack for multi-module system equipped with Concept³

Description

- Compact multifunction cabinet with stainless steel body with Concept3 module, hand dryer, mixer tap with laser sensor and automatic soap dispenser.
- Stainless steel body.
- Designed for installation behind the mirror.
- Laser sensor operated hand dryer. Automatic safety stop after a few seconds of operation.
- Mixer and automatic faucet.
- Suitable for uninterrupted use. Top quality components.
- Robust, vandal-proof and safe as it is built without sharp edges or other dangerous elements.
- Reduces water and soap consumption.

Suggested text for prescription

NOFER compact multifunction cabinet, to be installed behind the mirror, with Concept3 module. Consisting of hand dryer (power: 1200 W), mixer tap and soap dispenser. Stainless steel structure. Dimensions: 580 height x 600 width x 223 depth (mm).

Components

- Non-contact use, prevents the spread of germs.
- Regulation of the times and distance of the laser sensors from the module itself.
- Hand dryer has automatic stop in case of vandalism.
- Includes a mixing valve for the faucet.

Technical Characteristics Hand Dryers

Activation: Laser sensor
Mains voltage: 220-240 V - 50/60 Hz
Maximum consumption: 5,3 A
Total potential: 1200 W
Engine: universal 32000 rpm
Air flow rate: 1980 l/min
Temperature output: 40°C at 10 cm
Electrical insulation: Class II
Index protection: IP35
Sound level: 70 dBA
Drying time: 12-15 seconds

Technical Characteristics Soap dispenser

Activation: Adjustable laser sensor
Capacity: 1.2 liters

Technical Characteristics Faucet

Activación: Sensor láser
Caudal a 3 bar: 1.89 l/min
Presión de trabajo : 0.5-8 bar
Presión recomendada : 3 bar

Dimensional drawing

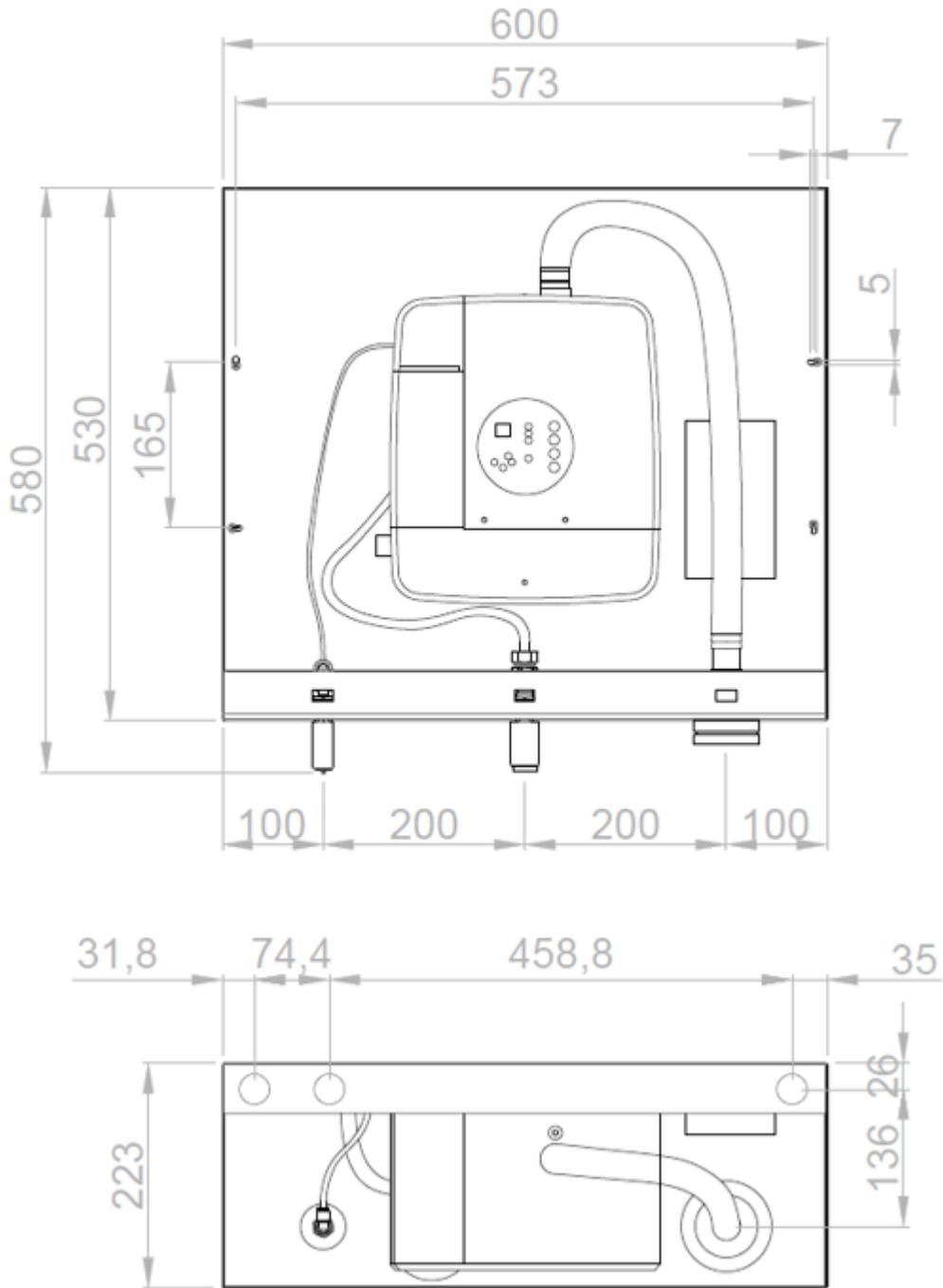

Ctra. Laureà Miró,
 385-387
 08980 | Sant
 Feliu de
 Llobregat,
 Barcelona - Spain
 T. +34 934 742
 423
 F. +34 934 743
 548
 nofer@nofer.com
 www.nofer.com
 www.nofer.com

RELATED
 PRODUCTS



12053.H1



12053.H2



12053.H3

These specifications may be modified and/or amended due to manufacturing requirements.