



Straight support bar to be fixed to the wall with 2 anchor points. Length 600 mm. Stainless steel. polished finish

Description

- Straight support bar to be fixed to the wall.
- Suitable for support in washbasins, wc-bidet, showers and bathtubs.
- Designed for toilets adapted for people with reduced mobility.
- Bacteriostatic stainless steel gloss finish.
- Also available in satin finish (NOFER 15054.60.S), matt black (NOFER 15054.60.N) and white (NOFER 15054.60.W).

Technical characteristics

Material: AISI 304 stainless steel

Finishing: polished

Bar diameter: Ø32 mm

Bar thickness: 1.5 mm

Length between support centers: 600 mm

Wall separation: 38 mm

Recommended installation height: 70-75 cm from floor to bar.

Maintenance

Stainless steel requires maintenance as dirt over time can damage the chromium (Cr) contained in stainless steel. We recommend a monthly cleaning with a specialized product for stainless steel.

Suggested text for prescription

NOFER fixed support bar made of AISI 304 stainless steel with glossy finish. Length between support centers: 600 mm. Bar Ø 32 x 1.5 mm.

Components

- Stainless steel support bar.
- Stainless steel screws included.
- Anticonductive kit included.

Fixing

- Two anchor points.

Dimensional drawing

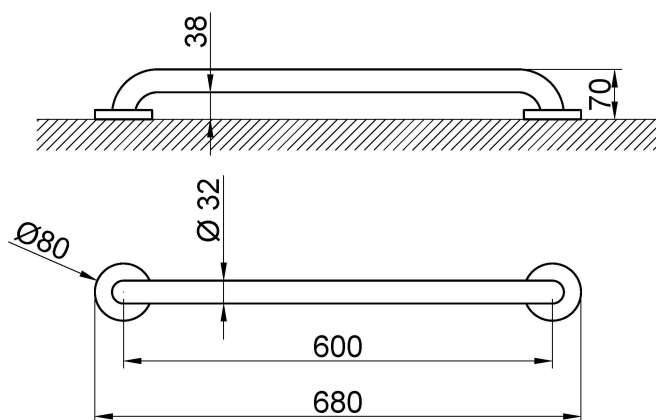



Ctra. Laureà Miró, 385-387
08980 | Sant Feliu de Llobregat,
Barcelona - Spain
T. +34 934 742 423
F. +34 934 743 548
nofer@nofer.com
www.nofer.com

RELATE
PRODUCT



15054.60.F



15054.60.N



15054.60.S

These specifications may be modified and/or amended due to manufacturing requirements.